



Tempe
Campus

Arizona State
University

Sun Devil Generations

For more family-friendly activities, visit alumni.asu.edu/SunDevilGenerations

Palm walk

Palm Walk is the most photographed site on the Tempe campus and extends from the University Bridge on the northside to the Sun Devil Fitness Complex on the south side. Can you count how many palm trees line this iconic sidewalk?



Foucault Pendulum

In the Bateman Physical Sciences Center F-wing, enjoy one of the world's largest Foucault pendulums, which measures the rotation of the Earth. Find the Foucault Pendulum and a public display of rock types in the lobby!

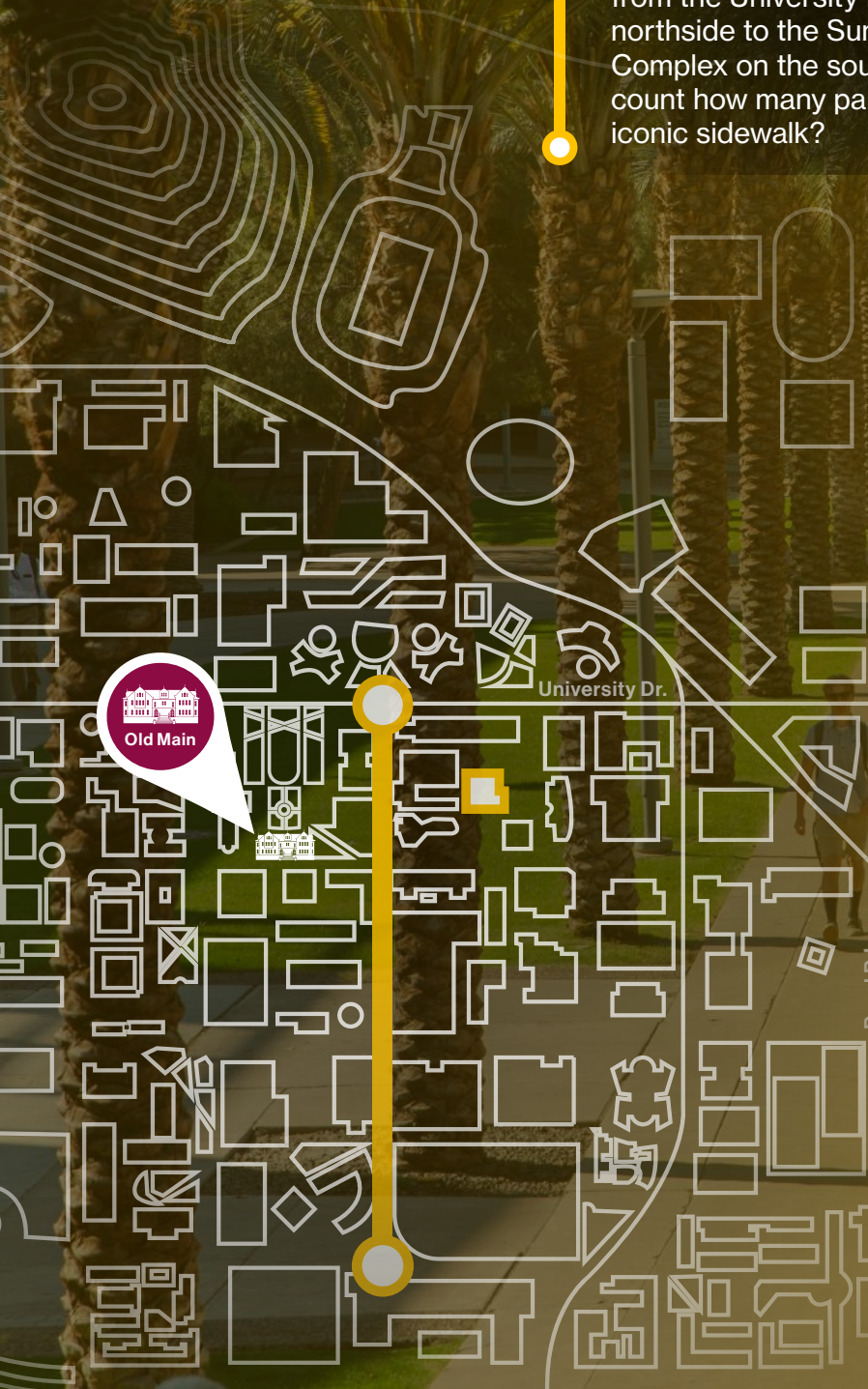

Apache Blvd.

Sun Devil Generations

For more family-friendly activities, visit alumni.asu.edu/SunDevilGenerations



'A' Mountain

The school changed its name to Arizona State Teachers College, and in 1938, the letter "A" was installed on Tempe Butte. The present "A" stands 60 feet tall and is built of reinforced steel and concrete in 1955. Take a selfie with the city of Tempe from the top of the mountain!



Secret Garden

The Secret Garden is a secluded courtyard nestled in between the Dixie Gammage Hall and West Hall buildings in the heart of the Tempe campus. It is just a walk from Hayden lawn or the COOR building. Find a quiet spot to read or relax.



Mill Ave.

University Dr.

University Dr.

Old Main

Sun Devil Generations

For more family-friendly activities, visit alumni.asu.edu/SunDevilGenerations



Go to a Gold Game

ASU has a longstanding rivalry with the University of Arizona. Check online to see if one of the Gold Games vs the Wildcats is happening while you are on campus. Stop in and cheer on your Sun Devils!



Reptile Row

Located in the halls of the Life Sciences A-wing is Reptile Row, where you'll find a living collection of Arizona native reptiles that include several species of rattlesnakes and Gila monsters. Take a self-guided tour through the halls to view the many living snakes and reptiles of Arizona!



University Dr.

Rural Rd.

Sun Devil Generations

For more family-friendly activities, visit alumni.asu.edu/SunDevilGenerations

ASU Art Museum

The ASU Art Museum has several exhibits available for public and virtual viewing. Admission is free, but limited! Open Wednesday through Saturday from 11 a.m. to 5 p.m. Find a thought-provoking piece of art to contemplate!



James Turrell ASU Skyspace Air Apparent

Come check out this contemporary work of architecture designed by “Light and Space” artist, James Turrell. Skyspace is an interpretation of ancient Hohokam shade ramadas, pit houses and baskets. Visit Interdisciplinary Science and Technology Building 4 for an interactive experience inside the space.

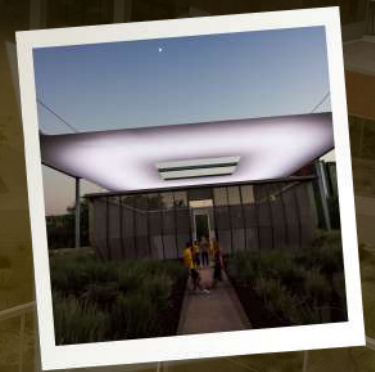

Mill Ave.

University Dr.

Old Main

Rural Rd.

Apache Blvd.